

# Type **TW04**

**WEH<sup>®</sup> Connector for pressure and vacuum testing**

of components with male thread



## General

### DESCRIPTION



#### Features

- Pressure-tight connections by hand-tightening
- Simple seal replacement
- Ergonomic design
- High-grade materials

The WEH® TW04 Quick connector provides fast leak tight connections to components with male threads for testing, filling, plugging and venting.

Only hand-tighten the connector onto the thread until the o-ring seal contacts the test piece. The TW04 seals without wrenches, sealants or tape. NBR seals meet most industrial requirements.

WEH® TW04 is available as a connector with media inlet and as a plug.

#### Application

Quick connector for pressure and vacuum testing of components with male thread, e.g. fittings, fixtures, tubes, boilers, tanks, radiators, etc.

### TECHNICAL DATA

Characteristics	Basic version
Operating pressure PS	Vacuum up to max. 5,000 psi
Temperature range	+41 °F up to +176 °F
Leak rate	$1 \times 10^{-3}$ mbar x l/s
Material	Corrosion resistant stainless steel
Sealing material	NBR

Other designs on request

#### Example of use:



#### Construction of TW04 (for male thread):

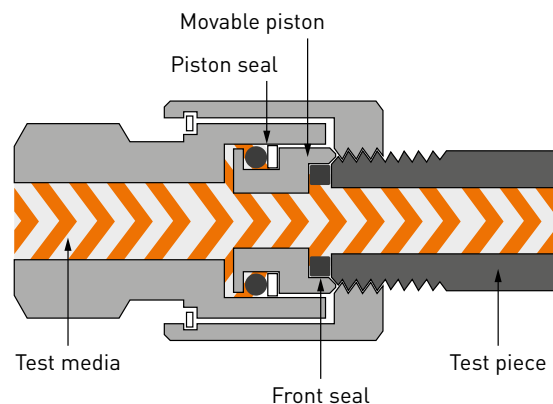

## Ordering

### ORDERING | WEH® TW04 Quick connector

approx. dimensions (mm)

Connector with media inlet

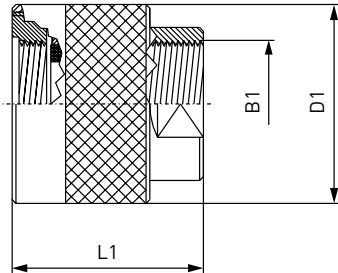
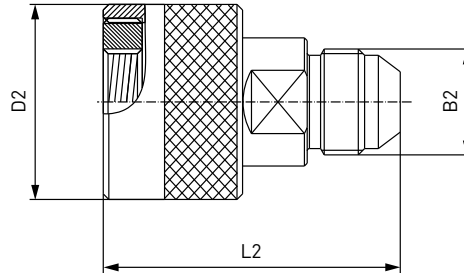
Connector with media inlet  
(SAE J512, J513, J514)

Plug

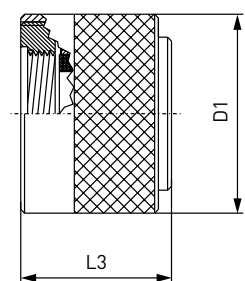

Body size	Inlet B1 (female thread)	Inlet B2 (UNF/Umale thread)	D1	D2	L1	L2 (SAE J512 / SAE J513)	L2 (SAE J514)	L3
1	G1/8"	-	22.0	-	35.5	-	-	25.5
2	G1/4"	-4 (7/16"-20)	27.0	25.0	40.5	45.0	46.5	26.5
3	G3/8"	-6 (9/16"-18)	32.0	30.0	38.0	48.0	48.0	28.0
4	G3/8"	-8 (3/4"-16)	35.0	35.0	38.0	55.5	53.5	28.0
5	G1/2"	-10 (7/8"-14)	37.0	38.0	51.0	63.0	59.5	33.0
6	G3/4"	-12 (1 1/16"-12)	44.0	44.0	52.0	66.5	63.5	34.0
7	G1"	-	52.0	-	60.0	-	-	39.5

## Ordering

Metric ISO thread to DIN 13 - *Plane surface smooth and burr free*

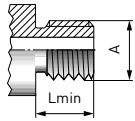

Part No.		Body size	Thread A (male thread)	Inlet B1 (female thread)	Max. operating pressure (PS)	Lmin*
Connector	Plug					
<b>C1-12406</b>	<b>C1-12410</b>	1	M10x1.0	G1/8"	725 psi	8.0
<b>C1-12414</b>	<b>C1-12419</b>	2	M12x1.5	G1/4"	725 psi	10.0
<b>C1-12415</b>	<b>C1-12418</b>	2	M14x1.5	G1/4"	725 psi	10.0
<b>C1-12422</b>	<b>C1-12425</b>	3	M16x1.5	G3/8"	725 psi	11.0
<b>C1-12426</b>	<b>C1-12427</b>	4	M18x1.5	G3/8"	725 psi	11.0
<b>C1-12431</b>	<b>C1-12436</b>	5	M20x1.5	G1/2"	725 psi	11.0
<b>C1-12432</b>	<b>C1-12435</b>	5	M22x1.5	G1/2"	725 psi	12.0
<b>C1-12439</b>	<b>C1-12444</b>	6	M24x1.5	G3/4"	725 psi	14.0
<b>C1-12440</b>	<b>C1-12443</b>	6	M26x1.5	G3/4"	725 psi	14.0

\* Lmin: minimum thread length

Whitworth tube thread to ISO 7/1 or DIN EN ISO 228-1 - *Plane surface smooth and burr free*

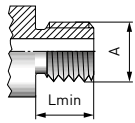

Part No.		Body size	Thread A (male thread)	Inlet B1 (female thread)	Max. operating pressure (PS)	Lmin*
Connector	Plug					
<b>C1-12405</b>	<b>C1-12409</b>	1	G1/8"	G1/8"	725 psi	12.0
<b>C1-12412</b>	<b>C1-12417</b>	2	G1/4"	G1/4"	725 psi	12.0
<b>C1-12421</b>	<b>C1-12424</b>	3	G3/8"	G3/8"	725 psi	12.0
<b>C1-12429</b>	<b>C1-12434</b>	5	G1/2"	G1/2"	725 psi	12.0
<b>C1-12438</b>	<b>C1-12442</b>	6	G3/4"	G3/4"	725 psi	12.0
<b>C1-12446</b>	<b>C1-12447</b>	7	G1"	G1"	725 psi	12.0

\* Lmin: minimum thread length

NPT thread (ANSI/ASME B1.20.1-1983) - *acc. to SAE J476a, plane surface smooth and burr free*

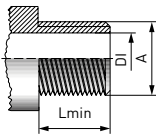

Part No.		Body size	Thread A (male thread)	Inlet B1 (female thread)	Max. operating pressure (PS)	DI max.	Lmin*
Connector	Plug						
<b>C1-12404</b>	<b>C1-12408</b>	1	1/8" NPT	G1/8"	725 psi	5.0	10.0
<b>C1-12411</b>	<b>C1-12416</b>	2	1/4" NPT	G1/4"	725 psi	7.0	14.0
<b>C1-12420</b>	<b>C1-12423</b>	3	3/8" NPT	G3/8"	725 psi	10.5	14.0
<b>C1-12428</b>	<b>C1-12433</b>	5	1/2" NPT	G1/2"	725 psi	14.0	19.0
<b>C1-12437</b>	<b>C1-12441</b>	6	3/4" NPT	G3/4"	725 psi	18.0	19.0
<b>C1-12445</b>	<b>C1-12448</b>	7	1" NPT	G1"	725 psi	24.0	20.5

\* Lmin: minimum thread length

## Ordering

### SAE J512 (45° cone), SAE J513

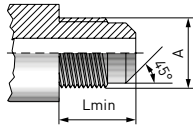

Part No.		Body size	Thread A (UNF/UN male thread)	Thread A (UNF/UN female thread)	Max. operating pressure (PS)	Lmin*
Connector	Plug					
<b>C1-11956</b>	<b>C1-119982</b>	2	-4 (7/16"-20)	-4 (7/16"-20)	5,000 psi	13.0
<b>C1-11957</b>	<b>C1-119980</b>	4	-8 (3/4"-16)	-8 (3/4"-16)	4,000 psi	19.0
<b>C1-11958</b>	<b>C1-119979</b>	5	-10 (7/8"-14)	-10 (7/8"-14)	4,000 psi	22.5
<b>C1-12976</b>	<b>C1-119978</b>	6	-12 (1 1/16"-14)	-12 (1 1/16"-14)	2,500 psi	25.5

\* Lmin: minimum thread length

### SAE J514 JIC 37°

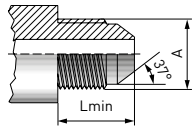

Part No.		Body size	Thread A (UNF/UN male thread)	Thread A (UNF/UN female thread)	Max. operating pressure (PS)	Lmin*
Connector	Plug					
<b>C1-35638</b>	<b>C1-119973</b>	2	-4 (7/16"-20)	-4 (7/16"-20)	5,000 psi	14.0
<b>C1-32445</b>	<b>C1-96356</b>	3	-6 (9/16"-18)	-6 (9/16"-18)	5,000 psi	14.5
<b>C1-32446</b>	<b>C1-17172</b>	4	-8 (3/4"-16)	-8 (3/4"-16)	4,000 psi	17.0
<b>C1-17173</b>	<b>C1-119975</b>	5	-10 (7/8"-14)	-10 (7/8"-14)	4,000 psi	19.5
<b>C1-32447</b>	<b>C1-119976</b>	6	-12 (1 1/16"-12)	-12 (1 1/16"-12)	2,500 psi	22.0

\* Lmin: minimum thread length

Other connector sizes and versions on request.

Required information for ordering see page 9, catalog no. 35.

## Other products

### OTHER PRODUCTS

You will find more products in our current catalog no. 35



Further information on our homepage  
[www.weh.com](http://www.weh.com)

#### Abbreviations/Definition

Explanation of abbreviations see technical appendix in the catalogue or [www.weh.com](http://www.weh.com)

#### Safe product selection

Our WEH® Products are designed to be operated by qualified professional users (insofar as WEH® Products are also designed to be operated by other users in individual cases, this is explicitly stated in the corresponding operating instructions). You alone are responsible for the selection of WEH® Products and their configuration according to the requirements of your system. In doing so, please particularly consider your intended use, your performance data, your material compatibility, your system concept and your system limits as well as your technical and legal requirements for operation, handling and maintenance. The quality and safety of WEH® Products is our highest priority. For this reason, WEH® Products may not be used outside the specifications in the relevant data sheets and product descriptions. We also strongly recommend that you refrain from using third-party spare parts or a combination of WEH® Products with unsuitable third-party products. You alone are responsible for reviewing the suitability of third-party products. WEH® Products and WEH® Spare parts comply with our quality and safety standards.

#### Explanation on the Pressure Equipment Directive

These WEH® Products are generally and exclusively classified as pressure accessories for piping in accordance with Article 2 (5) of the Pressure Equipment Directive 2014/68/EU. These WEH® Products may not be used (i) as safety accessories or (ii) for vessels as defined by the Pressure Equipment Directive 2014/68/EU. Therefore, the application of these WEH® Products must comply with their classification as pressure accessories for piping. The assessment with regard to a different classification can, however, be made on request.

#### External change management

WEH reserves the right to update, optimise and adjust its products continuously. This may result in corresponding changes of the product. Customers will be informed proactively or unsolicited by WEH only in individual cases about product updates, product optimisations and/or product adaptations that have been carried out. You are free to contact WEH at any time to request information about any product updates, product optimisations and/or product adjustments.

© All rights reserved, WEH GmbH. Any unauthorized use is strictly forbidden. Subject to alteration.  
No liability will be assumed for any content. Herewith previous versions are no longer valid.

### » Contacting

For queries and further information, please do not hesitate to contact us.

Manufacturer:

**WEH GmbH Precision Connectors**

Josef-Henle-Str. 1  
89257 Illertissen / Germany

Phone: +49 7303 9609-0  
Fax: +49 7303 9609-9999

Email: [sales@weh.com](mailto:sales@weh.com)  
[www.weh.com](http://www.weh.com)