

Type **TW108**

WEH[®] Connector for filling and evacuating refrigerants

during maintenance of automotive air conditioning equipment



General

DESCRIPTION



- Features**
- Connection in seconds
 - No hand tightening required
 - WEH® Jaw locking mechanism
 - High-grade materials

The WEH® TW108 Quick Connector is a good reasonably priced alternative to the WEH® TW110 for connections where continuous use is not required. It is therefore the ideal choice for leak-tight filling during maintenance work. All parts are made of high-grade materials with brass clamping jaws. The integrated shut-off valve prevents the escape of ozone depleting refrigerants to a minimal residual volume.

The TW108 quick connector is available with a red coloured grip sleeve for the customer’s high pressure connection port and also with a blue coloured grip sleeve for the customer’s low pressure connection port.

Application
Quick connector for filling and evacuating refrigerants during maintenance of automotive air conditioning equipment.

TECHNICAL DATA

Characteristics	Basic version
Operating pressure PS	Max. 510 psi
Temperature range	+14 °F up to +176 °F
Medium	Refrigerants (please indicate when ordering)
Actuation	Manual actuation via sliding sleeve
Material	Brass, anodized aluminium
Sealing material	Dependant on medium
Design	Incl. integrated shut-off valve

Other designs on request

Example of use:



Ordering

ORDERING | WEH® TW108 Quick Connector

approx. dimensions (mm)

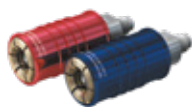
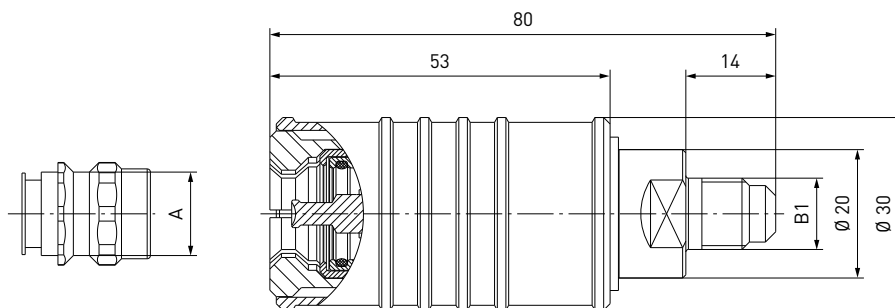

Part No.	Description	Connection A	Inlet B1 (male thread)
C1-14455	TW108 - high pressure (red)	Ø 13	UNF 7/16"-20*
C1-14458	TW108 - low pressure (blue)	Ø 11	UNF 7/16"-20*
C1-14455/1	TW108 - high pressure (red)	Ø 13	UNF 5/8"-18*
C1-14458/1	TW108 - low pressure (blue)	Ø 11	UNF 5/8"-18*

* acc. to SAE J513 (45°)

Other connector sizes and versions on request.

Other products

OTHER PRODUCTS

You will find more products in our current catalog no. 40



Further information on our homepage
www.weh.com

Abbreviations/Definition

Explanation of abbreviations see technical appendix in the catalogue or www.weh.com

Safe product selection

Our WEH® Products are designed to be operated by qualified professional users (insofar as WEH® Products are also designed to be operated by other users in individual cases, this is explicitly stated in the corresponding operating instructions). You alone are responsible for the selection of WEH® Products and their configuration according to the requirements of your system. In doing so, please particularly consider your intended use, your performance data, your material compatibility, your system concept and your system limits as well as your technical and legal requirements for operation, handling and maintenance. The quality and safety of WEH® Products is our highest priority. For this reason, WEH® Products may not be used outside the specifications in the relevant data sheets and product descriptions. We also strongly recommend that you refrain from using third-party spare parts or a combination of WEH® Products with unsuitable third-party products. You alone are responsible for reviewing the suitability of third-party products. WEH® Products and WEH® Spare parts comply with our quality and safety standards.

Explanation on the Pressure Equipment Directive

These WEH® Products are generally and exclusively classified as pressure accessories for piping in accordance with Article 2 (5) of the Pressure Equipment Directive 2014/68/EU. These WEH® Products may not be used (i) as safety accessories or (ii) for vessels as defined by the Pressure Equipment Directive 2014/68/EU. Therefore, the application of these WEH® Products must comply with their classification as pressure accessories for piping. The assessment with regard to a different classification can, however, be made on request.

External change management

WEH reserves the right to update, optimise and adjust its products continuously. This may result in corresponding changes of the product. Customers will be informed proactively or unsolicited by WEH only in individual cases about product updates, product optimisations and/or product adaptations that have been carried out. You are free to contact WEH at any time to request information about any product updates, product optimisations and/or product adjustments.

© All rights reserved, WEH GmbH. Any unauthorized use is strictly forbidden. Subject to alteration.
No liability will be assumed for any content. Herewith previous versions are no longer valid.

» Contacting

For queries and further information, please do not hesitate to contact us.

Manufacturer:

WEH GmbH Precision Connectors

Josef-Henle-Str. 1
89257 Illertissen / Germany

Phone: +49 7303 9609-0
Fax: +49 7303 9609-9999

Email: sales@weh.com
www.weh.com