

# Type **TW800**

**WEH<sup>®</sup> Connector for pressure and function testing**

of components with bead, rim, collar, flange, stub or male thread



## General

### DESCRIPTION



#### Features

- Connection in seconds
- No hand tightening required
- WEH® Jaw locking mechanism
- High-grade materials
- Special versions possible

The WEH® TW800 Quick connector simplifies work procedures, shortens test times and improves productivity. Therefore the connector is ideal for pressure and function testing of components with a bead, rim, collar, flange, stub or male thread. In the automotive industry WEH® TW800 is also used for testing of fuel connections, connections for cold and hot water and other supply lines as well as refrigeration and air conditioning components.

By using high quality stainless steel the connectors meet the stringent requirements of industrial testing. The TW800 quick connector is designed for a pressure range up to max. 725 psi.

#### Application

Quick connector for pressure and function testing of components with bead, rim, collar, flange, stub or male thread, e.g. pressure vessels, compressors, heat exchangers, measuring devices, hoses, tubes, tanks, etc.

**Note:** For using the WEH® Connectors with pneumatic actuation and clamping jaws in an automated system please observe the technical note on page 89 in catalog no. 35.

### TECHNICAL DATA

Characteristics	Basic version
Operating pressure PS*	Vacuum up to max. 725 psi
Temperature range	+41 °F up to +176 °F
Leak rate	$1 \times 10^{-3}$ mbar x l/s
Material	Corrosion resistant stainless steel
Sealing material	NBR

\* depending on application

Other designs on request

#### Example of use:



## Ordering

### ORDERING | WEH® TW800 Quick connector

approx. dimensions (mm)

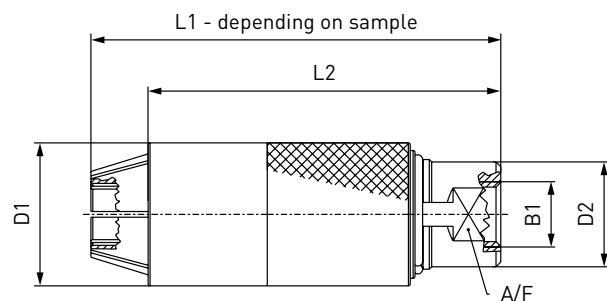

Body size	Inlet B1* (female thread)	D1	D2	L2	A/F
1	1/8" NPT	22.0	14.0	74.0	13
2	1/8" NPT	25.0	17.0	75.0	15
3	1/4" NPT	30.0	22.0	74.0	19
4	3/8" NPT	35.0	27.0	79.0	24
5	1/2" NPT	40.0	30.0	79.0	27
6	3/4" NPT	45.0	33.0	90.0	30
7	3/4" NPT	50.0	37.0	90.0	32
8	3/4" NPT	55.0	40.0	90.0	36
9	1" NPT	60.0	46.0	90.0	41
10	1 1/4" NPT	70.0	55.0	119.0	50

\* metric threads (G) available on request

Other body sizes on request

### Beads for hose connections

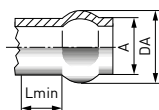

Part No.	Body size	External tube Ø A	Max. operating pressure (PS)	DA + 0,5 / - 0	Lmin*
<b>TW800B-W8378-021</b>	1	7.0	145 psi	8.0	8.5
<b>TW800B-W8379-021</b>	1	7.5	145 psi	8.5	8.5
<b>TW800B-W8380-021</b>	1	8.0	145 psi	9.0	8.5
<b>TW800B-W8381-021</b>	2	10.0	145 psi	11.0	8.5
<b>TW800B-W8382-041</b>	3	12.0	145 psi	13.0	10.0
<b>TW800B-W8383-041</b>	3	12.5	145 psi	13.5	10.0
<b>TW800B-W8384-041</b>	3	15.0	145 psi	16.0	10.5
<b>TW800B-W8385-061</b>	4	16.0	145 psi	17.0	10.5
<b>TW800B-W8386-061</b>	4	18.0	145 psi	19.0	10.5
<b>TW800B-W8387-061</b>	4	20.0	145 psi	21.0	14.5
<b>TW800B-W8388-081</b>	5	22.0	145 psi	23.0	14.5
<b>TW800B-W8389-081</b>	5	25.0	145 psi	26.0	14.5
<b>TW800B-W8390-121</b>	6	28.0	145 psi	30.0	16.5
<b>TW800B-W8391-121</b>	6	30.0	145 psi	32.0	16.5
<b>TW800B-W8392-121</b>	7	32.0	145 psi	34.0	16.5
<b>TW800B-W8393-121</b>	7	35.0	145 psi	37.0	16.0
<b>TW800B-W8394-121</b>	8	38.0	145 psi	40.0	16.5
<b>TW800B-W8395-121</b>	8	40.0	145 psi	42.0	16.5
<b>TW800B-W8396-121</b>	8	42.0	145 psi	44.0	16.5

\* Lmin: min. required length after bead for clamping

## Ordering

### Whitworth tube thread to DIN ISO 228-1 - Plane surface burr free

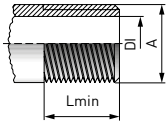

Part No.	Body size	Thread A (male thread)	Max. operating pressure (PS)	DI max.	Lmin*
<b>TW800G-W8372-021</b>	2	G1/8"	290 psi	5.0	12.0
<b>TW800G-W8373-041</b>	3	G1/4"	290 psi	8.5	12.0
<b>TW800G-W8374-061</b>	4	G3/8"	290 psi	10.5	12.0
<b>TW800G-W8375-081</b>	5	G1/2"	290 psi	14.5	12.0
<b>TW800G-W8376-121</b>	6	G3/4"	290 psi	20.0	12.0
<b>TW800G-W8377-121</b>	7	G1"	290 psi	25.0	12.0

\* Lmin: minimum thread length

### Threaded stem to DIN 7631 / DIN 7647 - Plane surface burr free

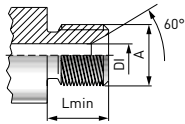

Part No.	Body size	Thread A** (male thread)	Max. operating pressure (PS)	DI max.	Lmin*
<b>TW800G-W8400-021</b>	2	M10x1.0	725 psi	3.0	8.0
<b>TW800G-W8401-041</b>	3	M12x1.5	725 psi	4.0	10.0
<b>TW800G-W8402-041</b>	3	M14x1.5	725 psi	6.0	10.0
<b>TW800G-W8403-061</b>	3	M16x1.5	725 psi	8.0	11.0
<b>TW800G-W8404-061</b>	4	M18x1.5	725 psi	10.0	11.0
<b>TW800G-W8405-081</b>	5	M22x1.5	725 psi	12.0	12.0
<b>TW800G-W8406-121</b>	6	M26x1.5	725 psi	15.0	12.0
<b>TW800G-W8407-121</b>	7	M30x1.5	725 psi	19.0	14.0
<b>TW800G-W8408-121</b>	8	M38x1.5	725 psi	25.0	14.0
<b>TW800G-W8409-161</b>	9	M45x1.5	725 psi	32.0	16.0

\* Lmin: minimum thread length

\*\* acc. to DIN 3853

### SAE J512 (45° cone), SAE J513

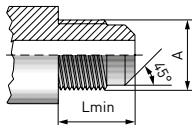

Part No.	Body size	Thread A (UNF/UN male thread)	Max. operating pressure (PS)	Lmin*
<b>TW800G-W8300-021</b>	1	-2 [5/16"-24]	725 psi	11.0
<b>TW800G-W8301-021</b>	2	-3 [3/8"-24]	725 psi	11.5
<b>TW800G-W8302-021</b>	2	-4 [7/16"-20]	725 psi	13.0
<b>TW800G-W8303-041</b>	3	-5 [1/2"-20]	725 psi	14.5
<b>TW800G-W8311-041</b>	3	-6 [9/16"-18]	725 psi	**
<b>TW800G-W8304-061</b>	4	-6 [5/8"-18]	725 psi	16.0
<b>TW800G-W8305-061</b>	4	-7 [11/16"-16]	725 psi	17.5
<b>TW800G-W8306-081</b>	4	-8 [3/4"-16]	725 psi	19.0
<b>TW800G-W8307-081</b>	5	-10 [7/8"-14]	725 psi	22.5
<b>TW800G-W8308-121</b>	6	-12 [1 1/16"-14]	725 psi	25.5
<b>TW800G-W8309-121</b>	8	-14 [1 1/4"-12]	725 psi	28.5
<b>TW800G-W8310-121</b>	8	-16 [1 3/8"-12]	725 psi	**

\* Lmin: minimum thread length

\*\* on request

## Ordering

SAE J514 JIC 37°

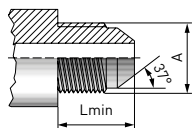

Part No.	Body size	Thread A [UNF/UN male thread]	Max. operating pressure (PS)	Lmin*
<b>TW800G-W8318-021</b>	1	-2 [5/16"-24]	725 psi	11.5
<b>TW800G-W8319-021</b>	2	-3 [3/8"-24]	725 psi	12.5
<b>TW800G-W8320-021</b>	2	-4 [7/16"-20]	725 psi	14.0
<b>TW800G-W8321-041</b>	3	-5 [1/2"-20]	725 psi	14.0
<b>TW800G-W8322-041</b>	3	-6 [9/16"-18]	725 psi	14.5
<b>TW800G-W8323-081</b>	5	-8 [3/4"-16]	725 psi	17.0
<b>TW800G-W8324-081</b>	5	-10 [7/8"-14]	725 psi	19.5
<b>TW800G-W8325-121</b>	6	-12 [1 1/16"-12]	725 psi	22.0
<b>TW800G-W8327-121</b>	8	-16 [1 5/16"-12]	725 psi	23.5

\* Lmin: minimum thread length

Other connector sizes and versions on request. Required information for ordering see page 9, catalog no. 35.

When ordering WEH® TW800 please indicate in addition to the details requested on page 9 in catalog no. 35 the following information:

### 1. Media port (Inlet B1)

The termination thread profile is determined in the part no., see example below:

Example: TW800G-W8372-021

The following standard thread profiles are available:

021 = 1/8" NPT	025 = G1/8"
041 = 1/4" NPT	045 = G1/4"
061 = 3/8" NPT	065 = G3/8"
081 = 1/2" NPT	085 = G1/2"*
121 = 3/4" NPT	125 = G3/4"
161 = 1" NPT	165 = G1"

\*G1/2" is compatible to 1/2" NPT

**Accessories**

**ACCESSORIES**

The following accessories are available for WEH® TW800:

**Screw plug**

If the WEH® Connector is to be used as a plug, the media inlet 'B1' will be sealed with a screw plug of brass (PVC sealing ring) for low pressure range. It is recommended that the media compatibility of the seal be tested by the customer!



Part No. G-thread*	Description	Connection (male thread)	Pressure range
E69-9200	Screw plug (low pressure)	G1/8"	0 - 725 psi (0 - 50 bar)
E69-9210	Screw plug (low pressure)	G1/4"	0 - 725 psi (0 - 50 bar)
E69-9220	Screw plug (low pressure)	G3/8"	0 - 725 psi (0 - 50 bar)
E69-9230	Screw plug (low pressure)	G1/2"	0 - 725 psi (0 - 50 bar)
W9338	Screw plug (low pressure)	G3/4"	0 - 725 psi (0 - 50 bar)

\* NPT-thread on request

**SPECIAL SOLUTIONS**

Examples:



TW800 with 90° lateral port



TW800 with pneumatic  
actuated grip sleeve



TW800 twin connector

## Other products

### OTHER PRODUCTS

You will find more products in our current catalog no. 35



Further information on our homepage  
[www.weh.com](http://www.weh.com)

#### Abbreviations/Definition

Explanation of abbreviations see technical appendix in the catalogue or [www.weh.com](http://www.weh.com)

#### Safe product selection

Our WEH® Products are designed to be operated by qualified professional users (insofar as WEH® Products are also designed to be operated by other users in individual cases, this is explicitly stated in the corresponding operating instructions). You alone are responsible for the selection of WEH® Products and their configuration according to the requirements of your system. In doing so, please particularly consider your intended use, your performance data, your material compatibility, your system concept and your system limits as well as your technical and legal requirements for operation, handling and maintenance. The quality and safety of WEH® Products is our highest priority. For this reason, WEH® Products may not be used outside the specifications in the relevant data sheets and product descriptions. We also strongly recommend that you refrain from using third-party spare parts or a combination of WEH® Products with unsuitable third-party products. You alone are responsible for reviewing the suitability of third-party products. WEH® Products and WEH® Spare parts comply with our quality and safety standards.

#### Explanation on the Pressure Equipment Directive

These WEH® Products are generally and exclusively classified as pressure accessories for piping in accordance with Article 2 (5) of the Pressure Equipment Directive 2014/68/EU. These WEH® Products may not be used (i) as safety accessories or (ii) for vessels as defined by the Pressure Equipment Directive 2014/68/EU. Therefore, the application of these WEH® Products must comply with their classification as pressure accessories for piping. The assessment with regard to a different classification can, however, be made on request.

#### External change management

WEH reserves the right to update, optimise and adjust its products continuously. This may result in corresponding changes of the product. Customers will be informed proactively or unsolicited by WEH only in individual cases about product updates, product optimisations and/or product adaptations that have been carried out. You are free to contact WEH at any time to request information about any product updates, product optimisations and/or product adjustments.

© All rights reserved, WEH GmbH. Any unauthorized use is strictly forbidden. Subject to alteration.  
No liability will be assumed for any content. Herewith previous versions are no longer valid.

#### » Contacting

For queries and further information, please do not hesitate to contact us.

Manufacturer:

**WEH GmbH Precision Connectors**

Josef-Henle-Str. 1  
89257 Illertissen / Germany

Phone: +49 7303 9609-0  
Fax: +49 7303 9609-9999

Email: [sales@weh.com](mailto:sales@weh.com)  
[www.weh.com](http://www.weh.com)